

PARTS LIST			
ITEM	QTY	PART NUMBER	DESCRIPTION
1	1	CASSY000022	BASE
2	1	CASSY000090	ELECTRIC DUCT
3	1	CASSY000267	EXIT CHUTE
4	1	CASSY000320	FEEDING SYSTEM
5	1	CASSY000065	HOPPER POST
6	1	CASSY000047	PRE-ROLLER GUARD
7	1	CASSY000040	SCALE ASSY
8	1	CASSY000002	STATION #2 - CONE DISTRIBUTION
9	1	CASSY000089	STATION #2 - ROBOT UNIT PICK & PLACE
10	1	CASSY000003	STATION #3 - CONE FORMING
11	1	CASSY000100	STATION #4 - HOPPER POST
12	1	CASSY000005	STATION #5
13	1	CASSY000124	STATION #6
14	1	CASSY000233	STATION #7
15	1	CAPT000468	STATION #8
16	1	CASSY000088	STATION #9 - PICK AND PLACE
17	1	CASSY000067	STATION #10
18	1	CASSY000049	STATION #11 - BRUSH
19	1	CASSY000171	TUBE FEEDING SYSTEM

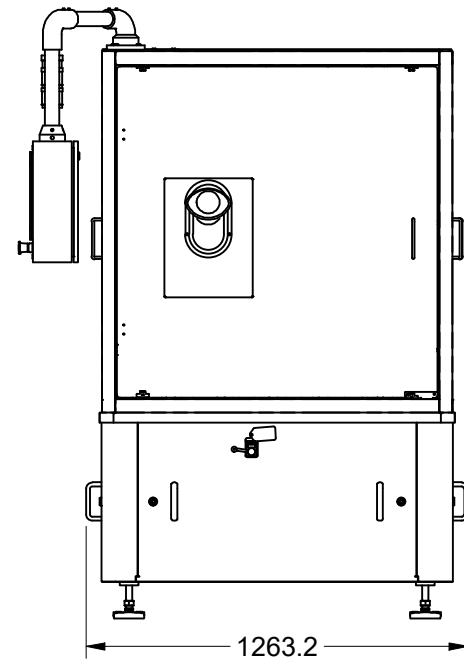

REVISION HISTORY			
REV	DESCRIPTION	DATE	APPROVED
1	CHANGED HOPPER WITH TUMBLER	2021-02-16	

	UNITS : mm [in]	MATERIAL :	PROJECT :
	SCALE : N/A	SURFACE FINISH :	DESCRIPTION : PREROLL-ER (ROTARY TUMBLER)
TEL : (514) 360-1292 www.procepack.com ALL RIGHTS RESERVED CONFIDENTIAL DO NOT REPRODUCE	NOTE : REMOVE ALL BURRS	GENERAL TOLERANCES (UNLESS SPECIFIED) X ± 1mm X.X ± 0.25mm ANGLE X° ± 1° X.XX ± 0.13mm ANGLE X.X° ± 0.5° X.XXX ± 0.013mm	DRAWN BY : D.MARTEL DATE : 2021-01-18
		DRAWING #: PREROLL-ER.idw	REV : 01 P. 1 of 14

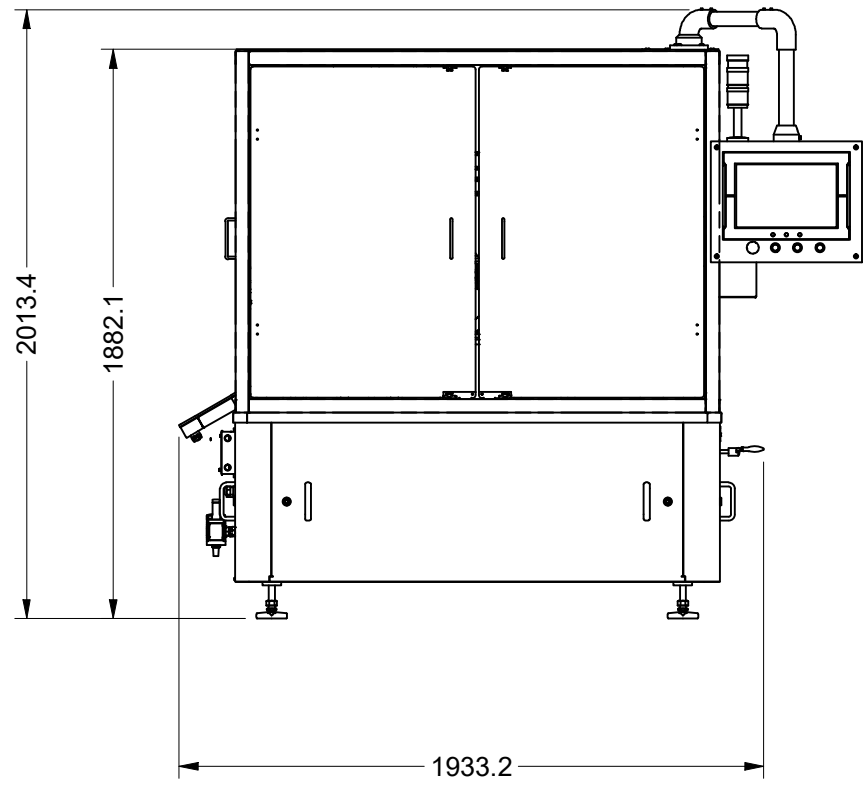
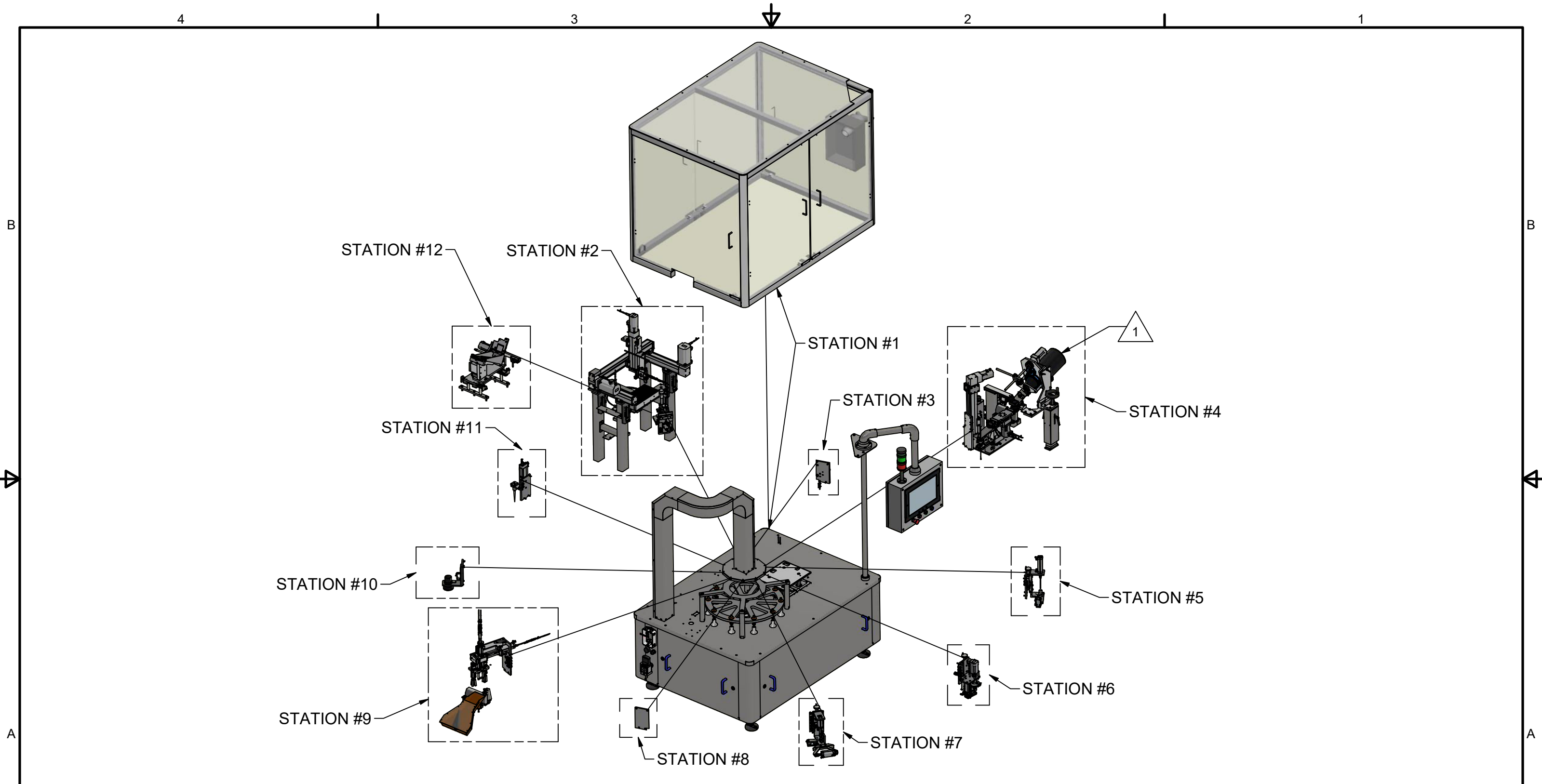

		UNITS : mm [in]	MATERIAL :	PROJECT :	
		SCALE : N/A		SURFACE FINISH :	
TEL : (514) 360-1292 www.procepack.com ALL RIGHTS RESERVED CONFIDENTIAL DO NOT REPRODUCE		GENERAL TOLERANCES (UNLESS SPECIFIED) X ± 1mm X.X ± 0.25mm ANGLE X° ± 1° X.XX ± 0.13mm ANGLE X.X° ± 0.5° X.XXX ± 0.013mm		DRAWN BY : D.MARTEL	
		NOTE : REMOVE ALL BURRS		DATE : 2021-01-18	
				DRAWING #: PREROLL-ER.idw	
				REV : 01 P. 2 of 14	

STATION 1
SCALE 1:15

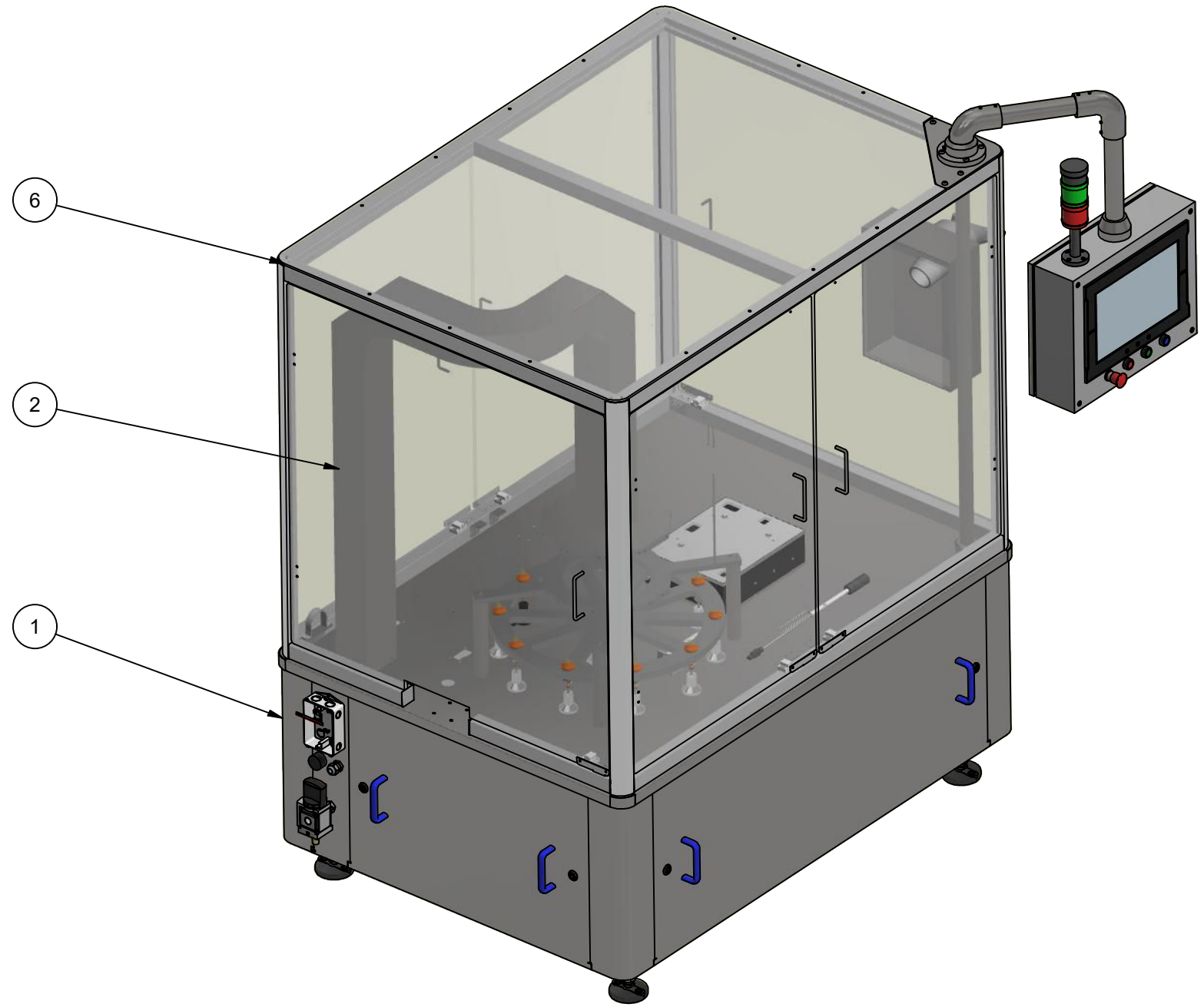

		UNITS : mm [in]	MATERIAL :	PROJECT :	
		SCALE : N/A		SURFACE FINISH :	DESCRIPTION : PREROLL-ER (ROTARY TUMBLER)
TEL : (514) 360-1292 www.procepack.com ALL RIGHTS RESERVED CONFIDENTIAL DO NOT REPRODUCE		NOTE : REMOVE ALL BURRS	GENERAL TOLERANCES (UNLESS SPECIFIED) X ± 1mm X.X ± 0.25mm ANGLE X° ± 1° X.XX ± 0.13mm ANGLE X.X° ± 0.5° X.XXX ± 0.013mm	DRAWN BY : D.MARTEL	DATE : 2021-01-18
				DRAWING #: PREROLL-ER.idw	REV : 01 P. 3 of 14

STATION 2
SCALE 1:10

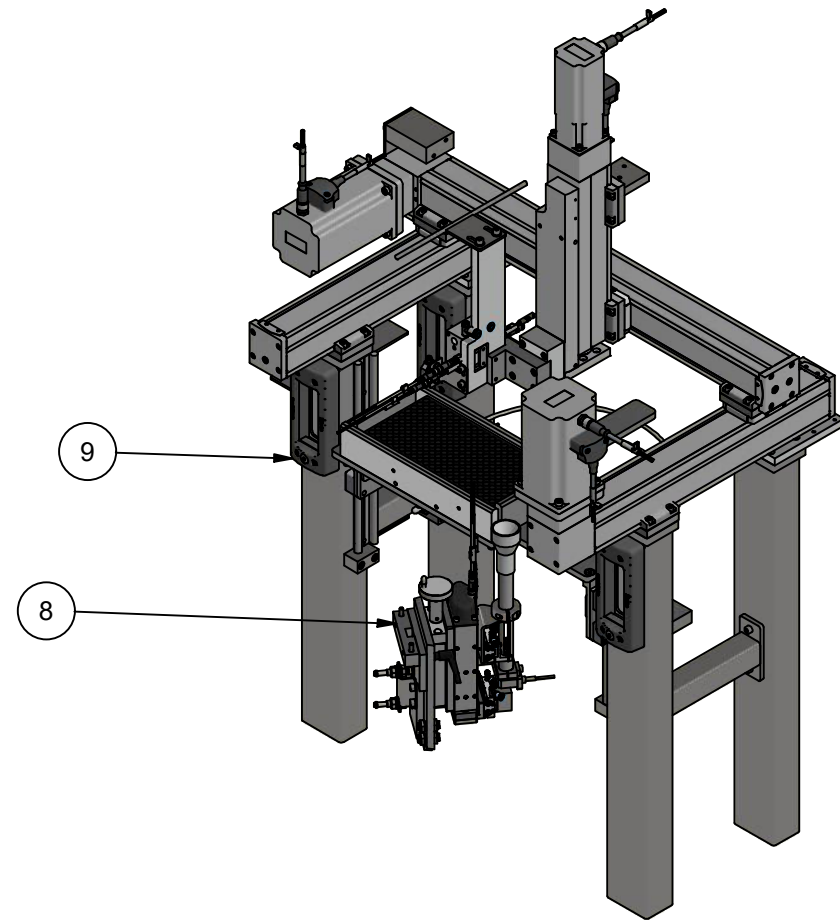

	UNITS : mm [in]	MATERIAL :	PROJECT :		
	SCALE : N/A		DESCRIPTION : PREROLL-ER (ROTARY TUMBLER)		
TEL : (514) 360-1292 www.procepack.com ALL RIGHTS RESERVED CONFIDENTIAL DO NOT REPRODUCE	NOTE : REMOVE ALL BURRS	GENERAL TOLERANCES (UNLESS SPECIFIED) X ± 1mm X.X ± 0.25mm ANGLE X° ± 1° X.XX ± 0.13mm ANGLE X.X° ± 0.5° X.XXX ± 0.013mm	DRAWN BY : D.MARTEL	DRAWING #: PREROLL-ER.idw	REV : 01
			DATE : 2021-01-18		P. 4 of 14

STATION 3
SCALE 1:2

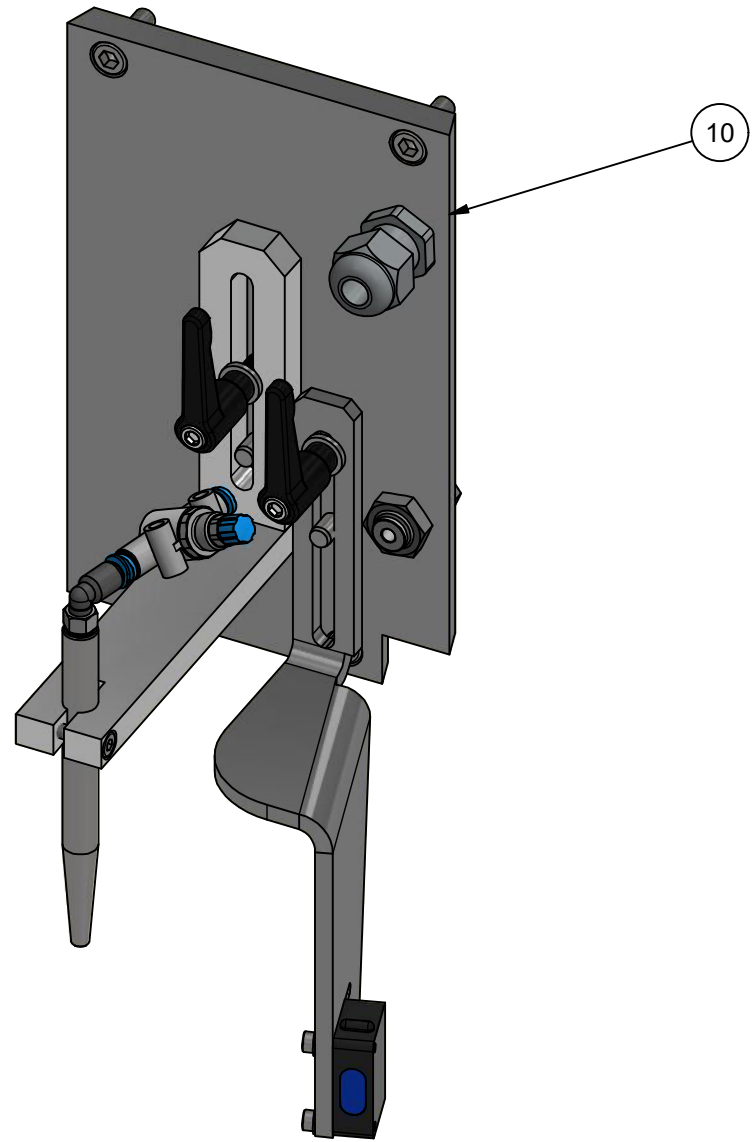

		UNITS : mm [in]	MATERIAL :	PROJECT :	
		SCALE : N/A		SURFACE FINISH :	DESCRIPTION : PREROLL-ER (ROTARY TUMBLER)
TEL : (514) 360-1292 www.procepack.com ALL RIGHTS RESERVED CONFIDENTIAL DO NOT REPRODUCE		NOTE : REMOVE ALL BURRS		GENERAL TOLERANCES (UNLESS SPECIFIED) X ± 1mm X.X ± 0.25mm ANGLE X° ± 1° X.XX ± 0.13mm ANGLE X.X° ± 0.5° X.XXX ± 0.013mm	
				DRAWN BY : D.MARTEL	
				DRAWING #: PREROLL-ER.idw	
				REV : 01 P. 5 of 14	

STATION 4
SCALE 1:5

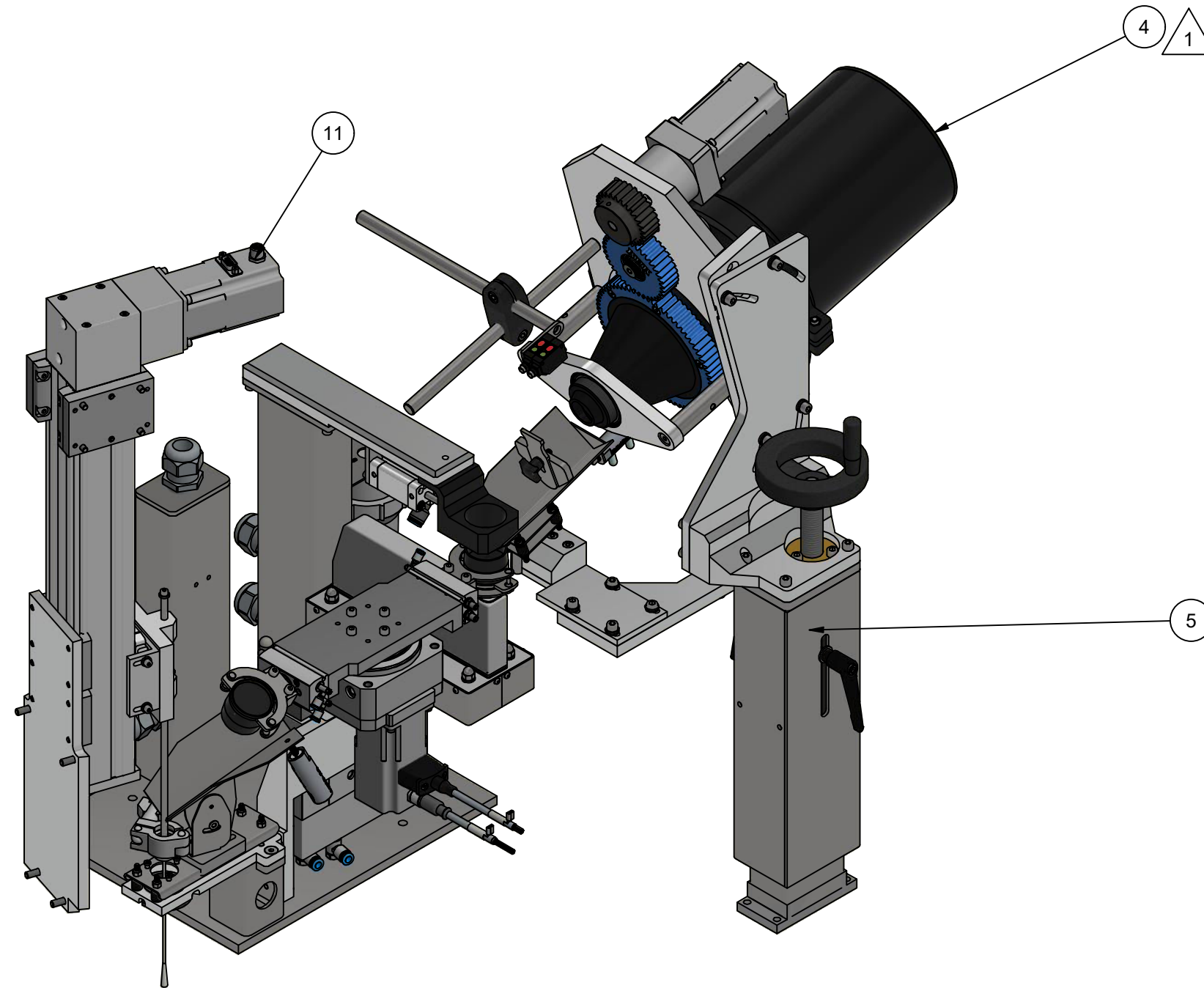

		UNITS : mm [in]	MATERIAL :	PROJECT :	
		SCALE : N/A		SURFACE FINISH :	DESCRIPTION : PREROLL-ER (ROTARY TUMBLER)
TEL : (514) 360-1292 www.procepack.com ALL RIGHTS RESERVED CONFIDENTIAL DO NOT REPRODUCE		NOTE : REMOVE ALL BURRS	GENERAL TOLERANCES (UNLESS SPECIFIED) X ± 1mm X.X ± 0.25mm ANGLE X° ± 1° X.XX ± 0.13mm ANGLE X.X° ± 0.5° X.XXX ± 0.013mm	DRAWN BY : D.MARTEL	DATE : 2021-01-18
				DRAWING #: PREROLL-ER.idw	REV : 01 P. 6 of 14

STATION 5
SCALE 1:2

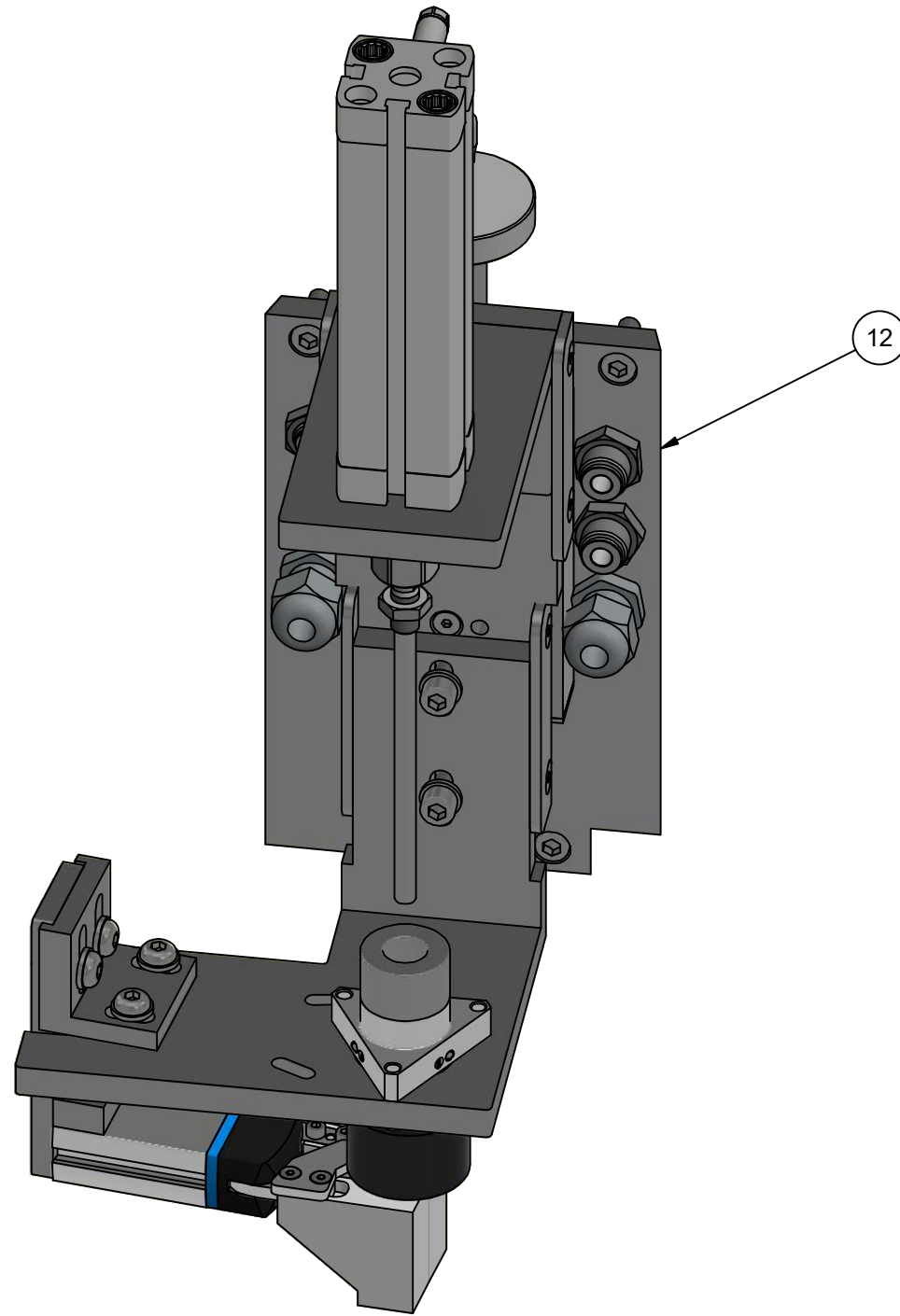

		UNITS : mm [in]	MATERIAL :	PROJECT :		
		SCALE : N/A		SURFACE FINISH :	DESCRIPTION : PREROLL-ER (ROTARY TUMBLER)	
TEL : (514) 360-1292 www.procepack.com ALL RIGHTS RESERVED CONFIDENTIAL DO NOT REPRODUCE		NOTE : REMOVE ALL BURRS	GENERAL TOLERANCES (UNLESS SPECIFIED) X ± 1mm X.X ± 0.25mm ANGLE X° ± 1° X.XX ± 0.13mm ANGLE X.X° ± 0.5° X.XXX ± 0.013mm		DRAWN BY : D.MARTEL	
			DATE : 2021-01-18		DRAWING #: PREROLL-ER.idw	
					REV : 01 P. 7 of 14	

STATION 6
SCALE 1:2

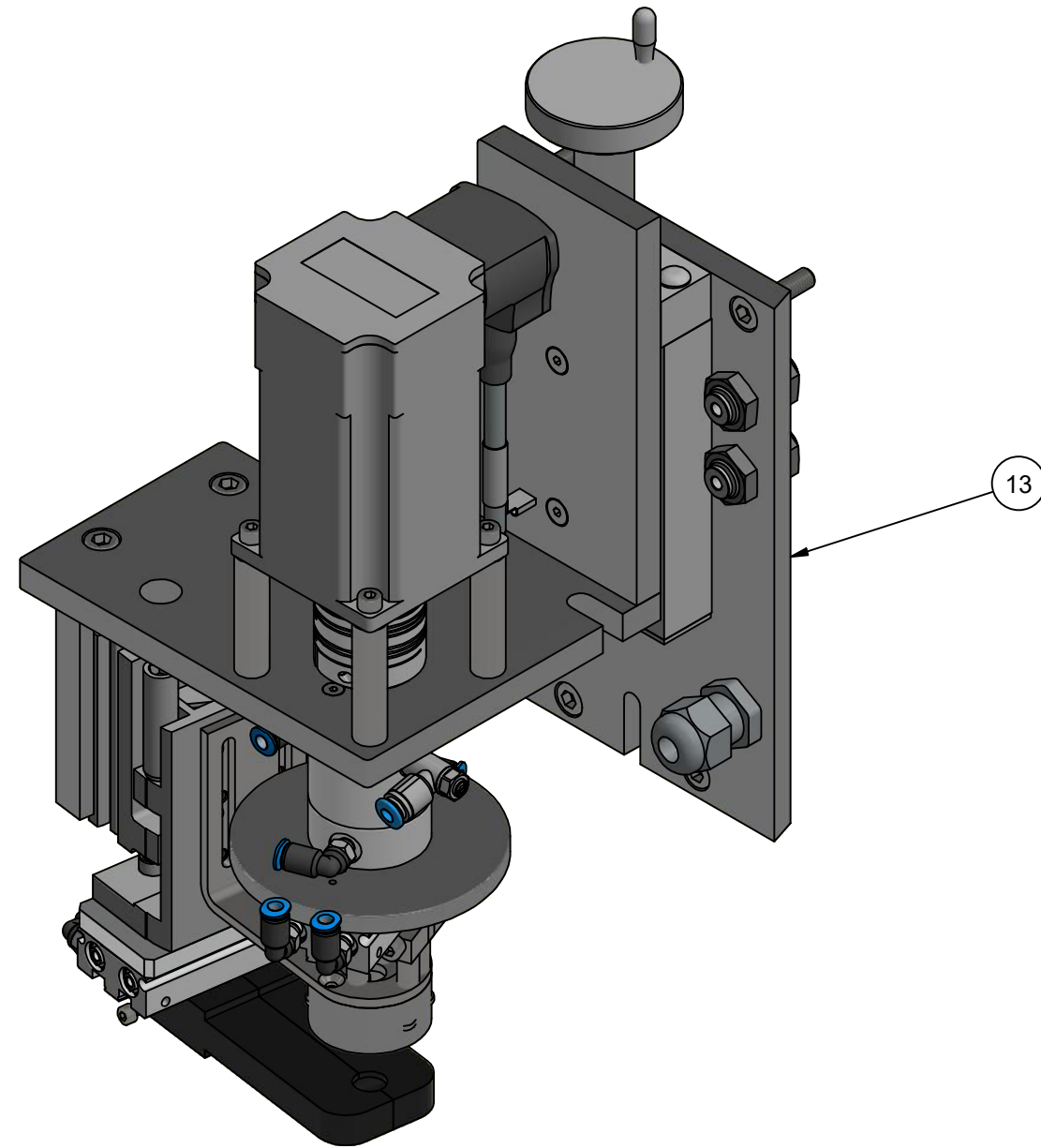

		UNITS : mm [in]	MATERIAL :	PROJECT :		
		SCALE : N/A		SURFACE FINISH :	DESCRIPTION : PREROLL-ER (ROTARY TUMBLER)	
TEL : (514) 360-1292 www.procepack.com ALL RIGHTS RESERVED CONFIDENTIAL DO NOT REPRODUCE		NOTE : REMOVE ALL BURRS	GENERAL TOLERANCES (UNLESS SPECIFIED) X ± 1mm X.X ± 0.25mm ANGLE X° ± 1° X.XX ± 0.13mm ANGLE X.X° ± 0.5° X.XXX ± 0.013mm		DRAWN BY : D.MARTEL	
			DATE : 2021-01-18		DRAWING #: PREROLL-ER.idw	REV : 01 P. 8 of 14

STATION 7
SCALE 1:2

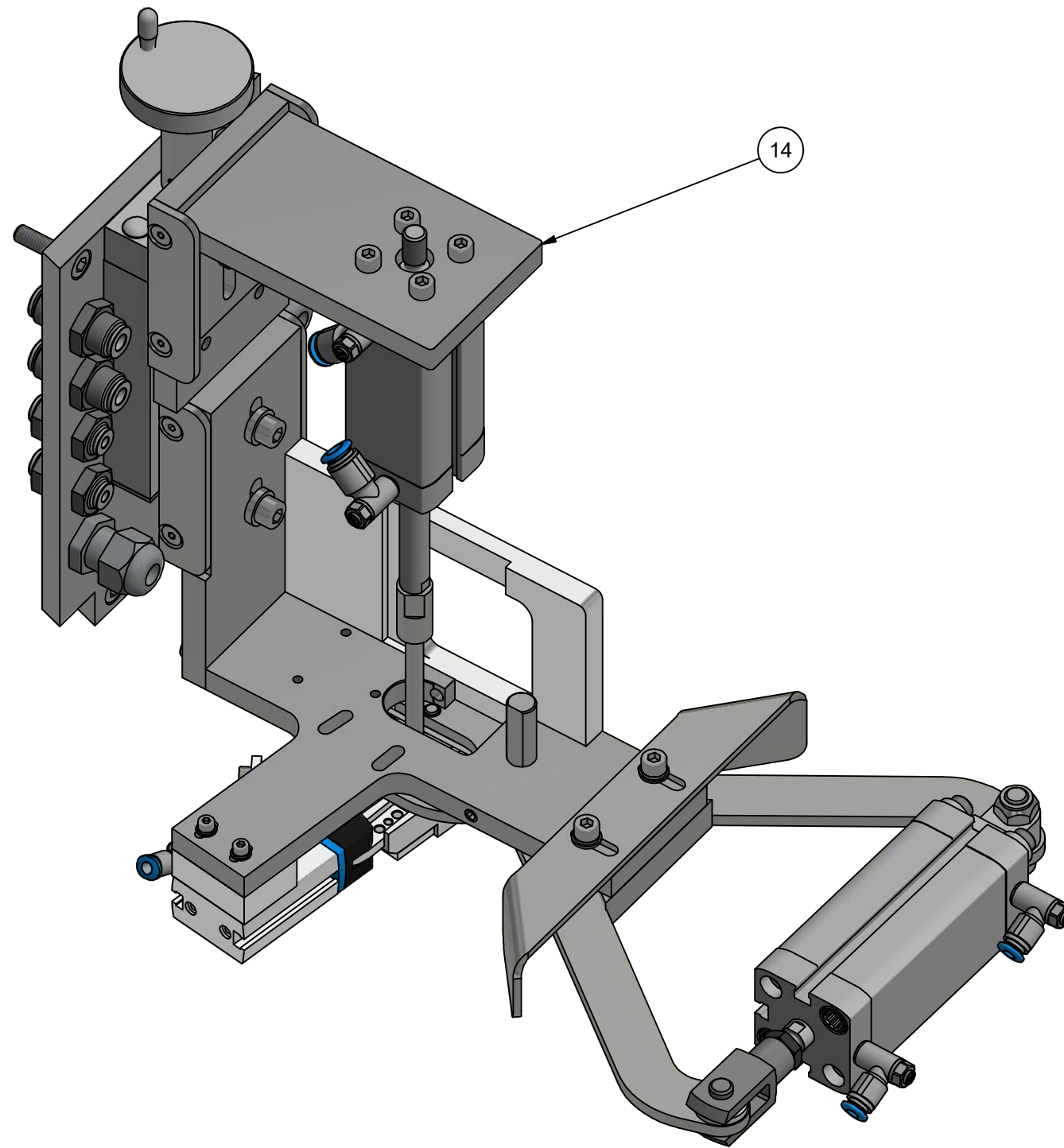

		UNITS : mm [in]	MATERIAL :	PROJECT :		
		SCALE : N/A		SURFACE FINISH :	DESCRIPTION : PREROLL-ER (ROTARY TUMBLER)	
TEL : (514) 360-1292 www.procepack.com ALL RIGHTS RESERVED CONFIDENTIAL DO NOT REPRODUCE		NOTE : REMOVE ALL BURRS	GENERAL TOLERANCES (UNLESS SPECIFIED) X ± 1mm X.X ± 0.25mm ANGLE X° ± 1° X.XX ± 0.13mm ANGLE X.X° ± 0.5° X.XXX ± 0.013mm		DRAWN BY : D.MARTEL	DATE : 2021-01-18
				DRAWING #: PREROLL-ER.idw	REV : 01 P. 9 of 14	

STATION 8
SCALE 1:1

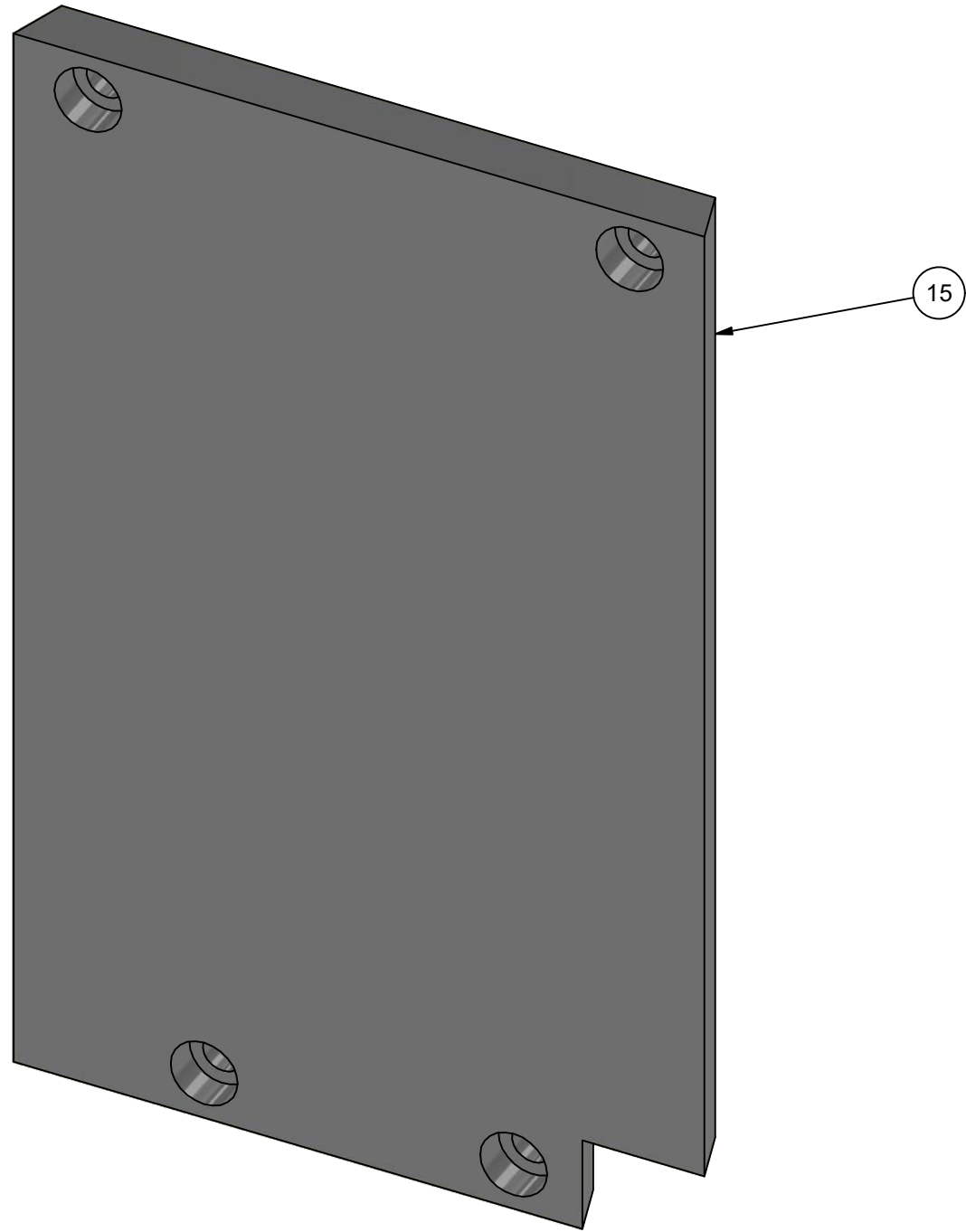

	UNITS : mm [in]	MATERIAL :	PROJECT :	
	SCALE : N/A		SURFACE FINISH :	
<small>TEL : (514) 360-1292 www.procepack.com ALL RIGHTS RESERVED CONFIDENTIAL DO NOT REPRODUCE</small>	<small>NOTE : REMOVE ALL BURRS</small>	<small>GENERAL TOLERANCES (UNLESS SPECIFIED) X ± 1mm X.X ± 0.25mm ANGLE X° ± 1° X.XX ± 0.13mm ANGLE X.X° ± 0.5° X.XXX ± 0.013mm</small>		<small>DRAWN BY : D.MARTEL</small>
		<small>DATE : 2021-01-18</small>		<small>DESCRIPTION : PREROLL-ER (ROTARY TUMBLER)</small>
			<small>DRAWING #: PREROLL-ER.idw</small>	<small>REV : 01</small>
			<small>P. 10 of 14</small>	

STATION 9
SCALE 1:5

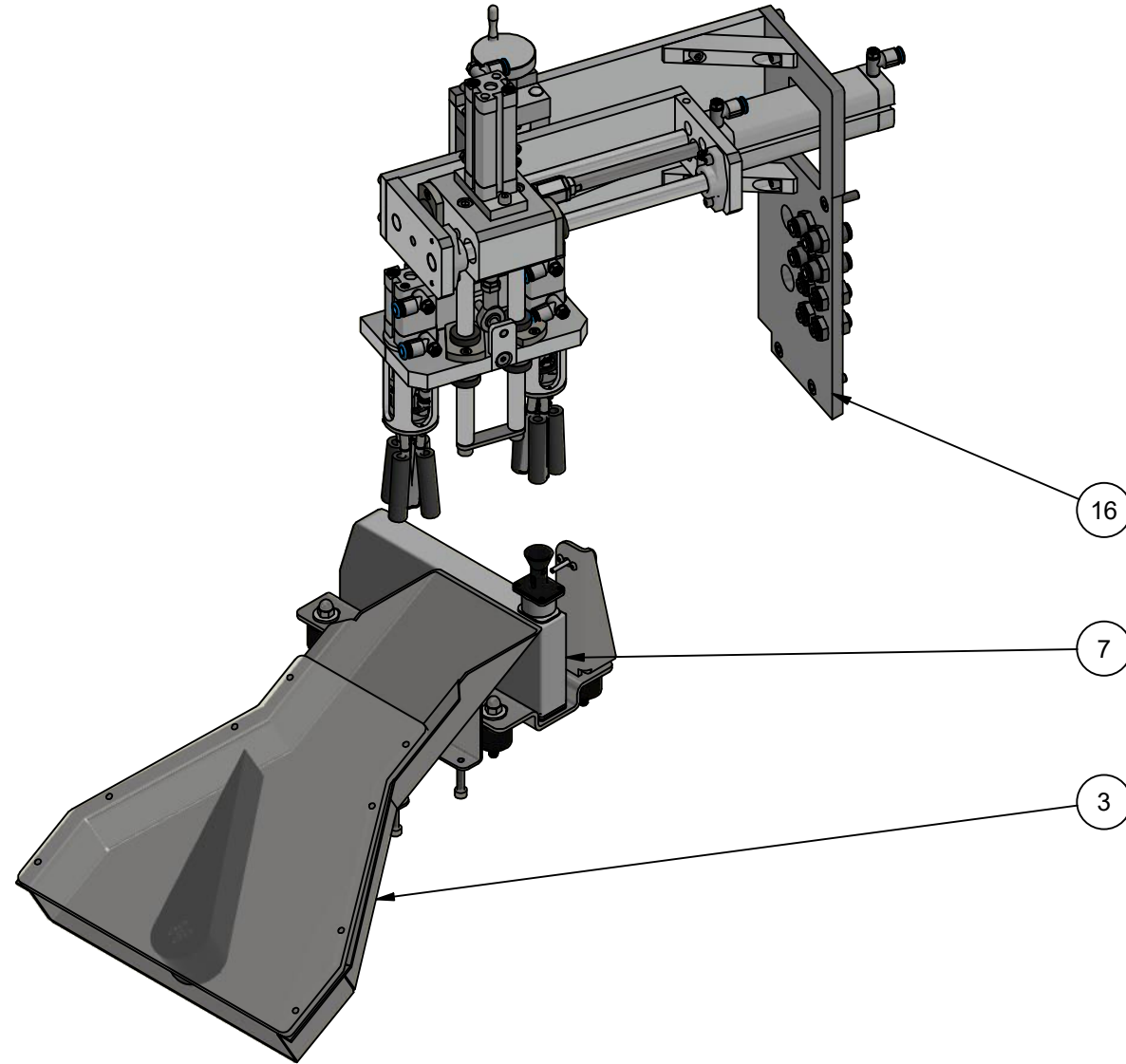

		UNITS : mm [in]	MATERIAL :	PROJECT :	
		SCALE : N/A		SURFACE FINISH :	DESCRIPTION : PREROLL-ER (ROTARY TUMBLER)
TEL : (514) 360-1292 www.procepack.com ALL RIGHTS RESERVED CONFIDENTIAL DO NOT REPRODUCE		NOTE : REMOVE ALL BURRS	GENERAL TOLERANCES (UNLESS SPECIFIED) X ± 1mm X.X ± 0.25mm ANGLE X° ± 1° X.XX ± 0.13mm ANGLE X.X° ± 0.5° X.XXX ± 0.013mm	DRAWN BY : D.MARTEL	DATE : 2021-01-18
				DRAWING #: PREROLL-ER.idw	REV : 01 P. 11 of 14

STATION 10
SCALE 1:2

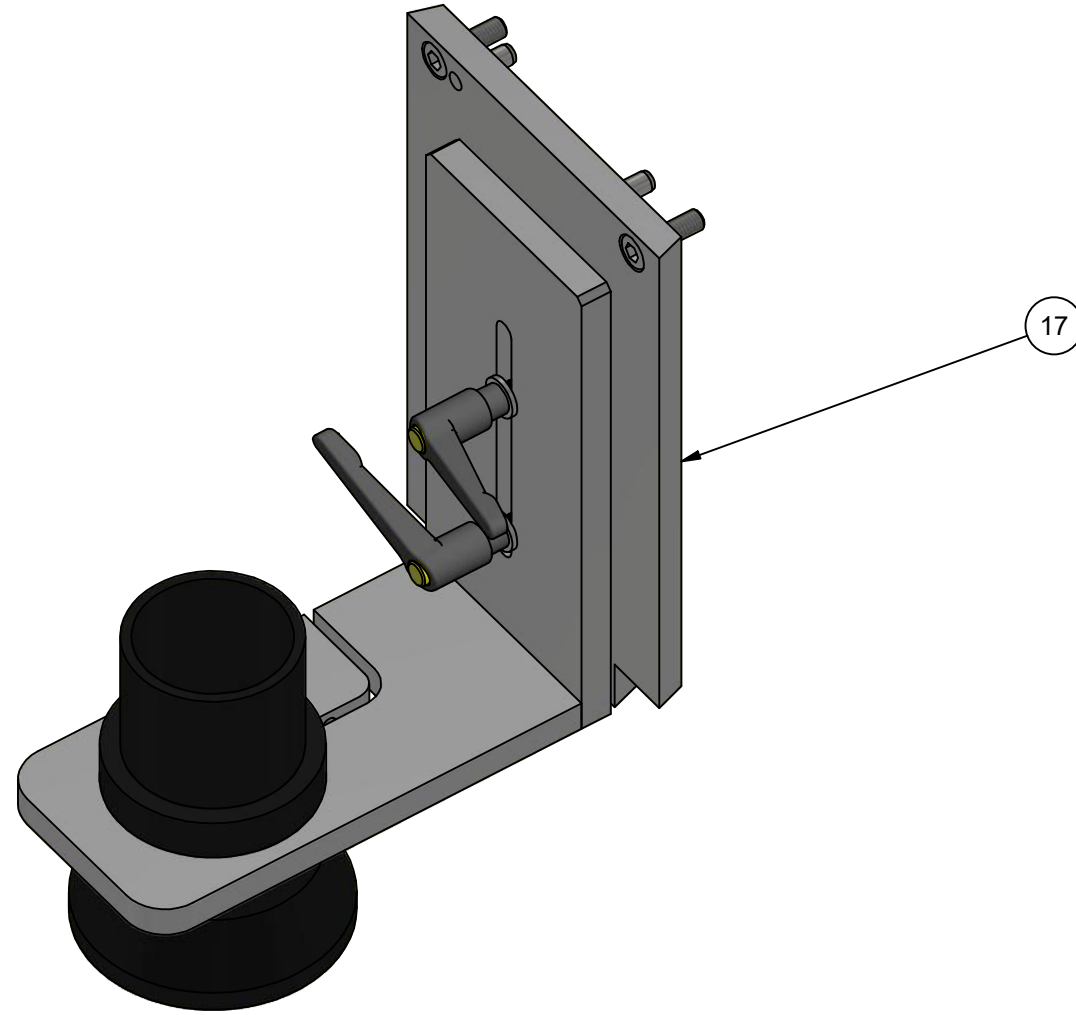

		UNITS : mm [in]	MATERIAL :	PROJECT :	
		SCALE : N/A		SURFACE FINISH :	DESCRIPTION : PREROLL-ER (ROTARY TUMBLER)
TEL : (514) 360-1292 www.procepack.com ALL RIGHTS RESERVED CONFIDENTIAL DO NOT REPRODUCE		NOTE : REMOVE ALL BURRS	GENERAL TOLERANCES (UNLESS SPECIFIED) X ± 1mm X.X ± 0.25mm ANGLE X° ± 1° X.XX ± 0.13mm ANGLE X.X° ± 0.5° X.XXX ± 0.013mm	DRAWN BY : D.MARTEL	DATE : 2021-01-18
				DRAWING #: PREROLL-ER.idw	REV : 01 P. 12 of 14

STATION 11
SCALE 1:2

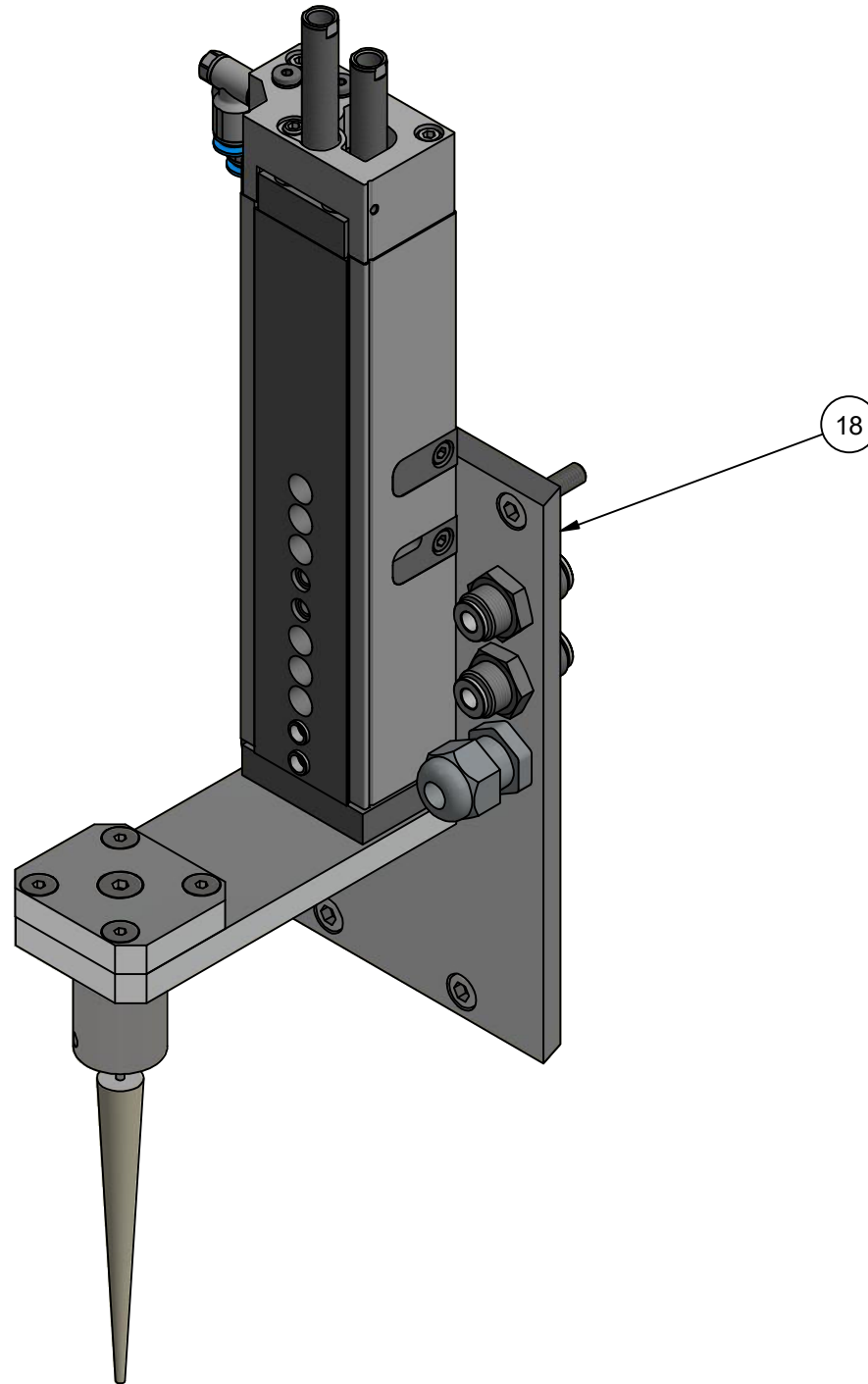

		UNITS : mm [in]	MATERIAL :	PROJECT :	
		SCALE : N/A		SURFACE FINISH :	DESCRIPTION : PREROLL-ER (ROTARY TUMBLER)
TEL : (514) 360-1292 www.procepack.com ALL RIGHTS RESERVED CONFIDENTIAL DO NOT REPRODUCE		NOTE : REMOVE ALL BURRS	GENERAL TOLERANCES (UNLESS SPECIFIED) X ± 1mm X.X ± 0.25mm ANGLE X° ± 1° X.XX ± 0.13mm ANGLE X.X° ± 0.5° X.XXX ± 0.013mm	DRAWN BY : D.MARTEL	DATE : 2021-01-18
				DRAWING #: PREROLL-ER.idw	REV : 01 P. 13 of 14

STATION 12
SCALE 1:5

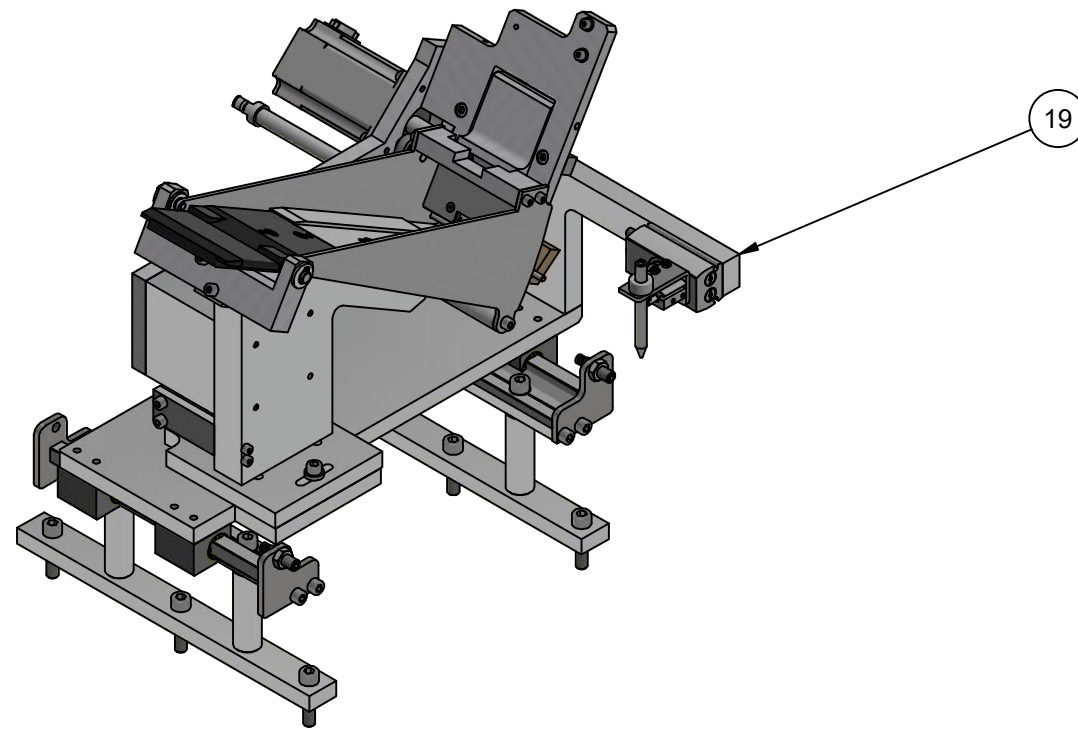

		UNITS : mm [in]	MATERIAL :	PROJECT :	
		SCALE : N/A		SURFACE FINISH :	
TEL : (514) 360-1292 www.procepack.com ALL RIGHTS RESERVED CONFIDENTIAL DO NOT REPRODUCE		NOTE : REMOVE ALL BURRS		GENERAL TOLERANCES (UNLESS SPECIFIED) X ± 1mm X.X ± 0.25mm ANGLE X° ± 1° X.XX ± 0.13mm ANGLE X.X° ± 0.5° X.XXX ± 0.013mm	
				DRAWN BY : D.MARTEL	
		DATE : 2021-01-18		DRAWING #: PREROLL-ER.idw	
				REV : 01 P. 14 of 14	